

AC charging cable - EV-T2G3P-1AC20A-4,0M2,5EHBK01



1627731

<https://www.phoenixcontact.com/gb/products/1627731>

Please be informed that the data shown in this PDF document is generated from our Online Catalog. Please find the complete data in the user documentation. Our General Terms of Use for Downloads are valid.



CHARX connect, AC charging cable with infrastructure charging plug and free cable end, with protective cap, Housing color black-black, For charging electric vehicles (EV) with alternating current (AC), compatible with type 2 infrastructure charging sockets at charging stations for electromobility (EVSE), Type 2, IEC 62196-2, 20 A / 250 V (AC), C-Line, "PHOENIX CONTACT" logo, cable: 4 m, black, spiraled

Product Description

AC charging cable with Infrastructure Plug and open cable end for charging electric vehicles (EV) with alternating current (AC), compatible with type 2 Infrastructure Socket Outlets at charging stations for E-Mobility (EVSE)

Your advantages

- Complete product range
- Convenient handling due to the ergonomic, triple award-winning design
- Available with your logo on request – for consistent branding of your charging station
- Longitudinal water tightness reliably prevents water ingress
- Developed and produced in accordance with the IATF 16949 automotive standard and ISO 9001
- Tested in accordance with automotive standards LV124, LV214, and LV215-2
- Tested in accordance with EV Ready 37 requirements
- Laser-marked mating face in accordance with DIN EN 17186

AC charging cable - EV-T2G3P-1AC20A-4,0M2,5EHBK01



1627731

<https://www.phoenixcontact.com/gb/products/1627731>

Commercial Data

| | |
|--------------------------------------|---------------|
| Item number | 1627731 |
| Packing unit | 1 pc |
| Minimum order quantity | 1 pc |
| Sales Key | XWBABC |
| Product Key | XWBABC |
| GTIN | 4055626349831 |
| Weight per Piece (including packing) | 1.547 kg |
| Weight per Piece (excluding packing) | 1.475 kg |
| Customs tariff number | 85444290 |
| Country of origin | PL |

AC charging cable - EV-T2G3P-1AC20A-4,0M2,5EHBK01

1627731

<https://www.phoenixcontact.com/gb/products/1627731>

Technical Data

Product properties

| | |
|-------------------|---|
| Product type | AC charging cable |
| Application | For charging electric vehicles (EV) with alternating current (AC) compatible with type 2 infrastructure charging sockets at charging stations for electromobility (EVSE) |
| Type | AC charging cable with infrastructure charging plug and free cable end with protective cap Housing color black-black |
| Affixed logo | "PHOENIX CONTACT" logo |
| Charging mode | Mode 3 |
| Charging standard | Type 2 |

Electrical properties

| | |
|-------------------------------|--|
| Number of phases | 1 |
| Type of signal transmission | Pulse width modulation |
| Type of charging current | AC single-phase |
| Note on the connection method | Crimp connection, cannot be disconnected |
| Coding | 680 Ω (between PE and PP) |
| Maximum capacity | 5 kW |

Power contact

| | |
|---------------|---------------|
| Number | 3 (L1, N, PE) |
| Rated voltage | 250 V AC |
| Rated current | 20 A |

Signal contact

| | |
|---------------|------------|
| Number | 2 (CP, PP) |
| Rated voltage | 30 V AC |
| Rated current | 2 A |

Dimensions

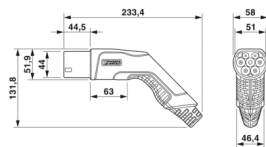
| | |
|---------------------|--|
| Dimensional drawing |  |
| Width | 58 mm (Infrastructure charging plug) |
| Height | 131.8 mm (Infrastructure charging plug) |
| Depth | 233.4 mm (Infrastructure charging plug) |

Material specifications

AC charging cable - EV-T2G3P-1AC20A-4,0M2,5EHBK01



1627731

<https://www.phoenixcontact.com/gb/products/1627731>

| | |
|------------------------------|--------------|
| Housing material | Plastic |
| Material of grip body | Soft plastic |
| Material protective cap | Soft plastic |
| Material mating face | Plastic |
| Material surface of contacts | Ag |

Design

| | |
|--------------------------|------------|
| Color Housing | black |
| Color Connection profile | black |
| Color Handle area | gray |
| Color Protective cap | black |
| Customer variations | On request |

Cable / line

| | |
|------------------------------|--|
| Cable length | 4 m |
| Wiring standards/regulations | prEN 50620 / DIN EN 50620 |
| Wiring certifications | VDE |
| Type of cable | spiraled |
| Cable structure | 3 x 2.5 mm ² + 1 x 0.5 mm ² |
| Cable type | Class 5 |
| External cable diameter | 10.2 mm ±0.3 mm |
| Outer sheath, material | TPE-U |
| External sheath, color | black |
| Block length | 0.68 m ±10 % |
| Coil diameter | 45 mm ±10 % |
| Effective length | max. 4 m ±5 % |
| Conductor resistance | ≤ 0.00798 Ω/m (based on a power core, at an ambient temperature of 20°C) |

Cable structure

| | |
|--------------------------------|-------------|
| Stripping length of the sheath | 70 mm ±5 mm |
|--------------------------------|-------------|

Mechanical properties

Design

| | |
|--------|--------|
| Design | C-Line |
|--------|--------|

Mechanical data

| | |
|------------------|---------|
| Insertion force | < 100 N |
| Withdrawal force | < 100 N |

Design

| | |
|---------------------|------------|
| Design | C-Line |
| Customer variations | On request |

Environmental and real-life conditions

AC charging cable - EV-T2G3P-1AC20A-4,0M2,5EHBK01



1627731

<https://www.phoenixcontact.com/gb/products/1627731>

Ambient conditions

| | |
|---|--------------------------|
| Ambient temperature (operation) | -30 °C ... 50 °C |
| Ambient temperature (storage/transport) | -40 °C ... 80 °C |
| Altitude | 5000 m (above sea level) |

Standards and regulations

Standards

| | |
|-----------------------|-------------|
| Standards/regulations | IEC 62196-2 |
|-----------------------|-------------|

AC charging cable - EV-T2G3P-1AC20A-4,0M2,5EHBK01



1627731

<https://www.phoenixcontact.com/gb/products/1627731>

Drawings

Dimensional drawing

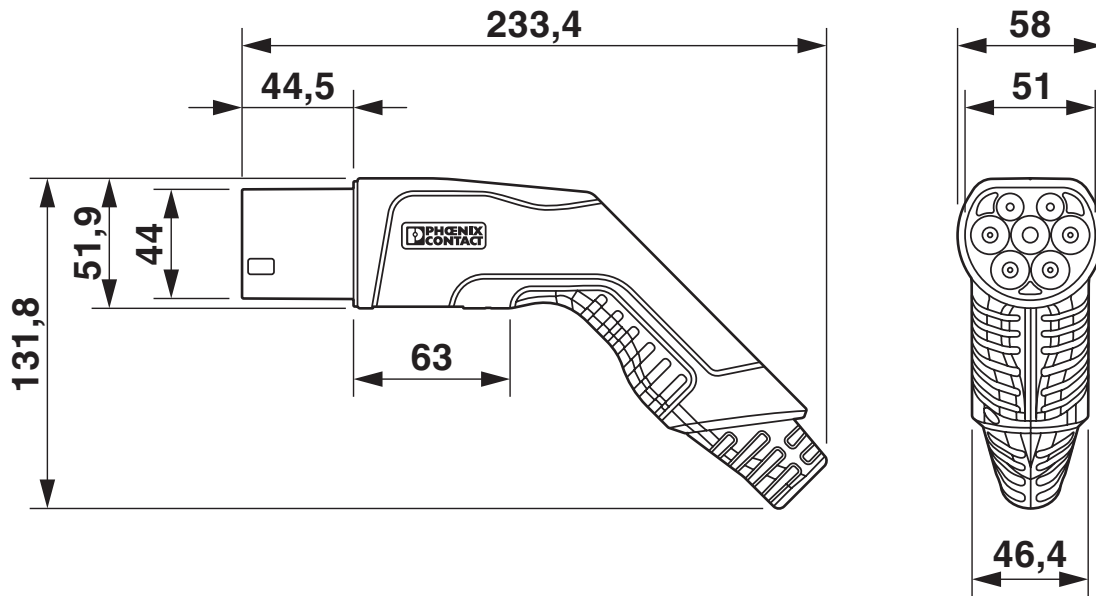

Infrastructure plug

Schematic diagram

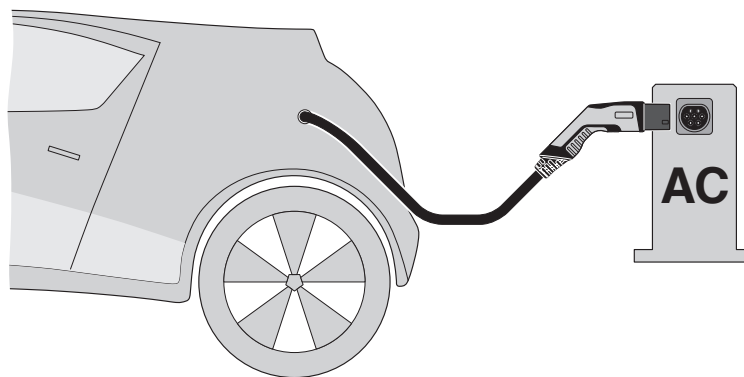

AC charging cable - EV-T2G3P-1AC20A-4,0M2,5EHBK01

1627731

<https://www.phoenixcontact.com/gb/products/1627731>

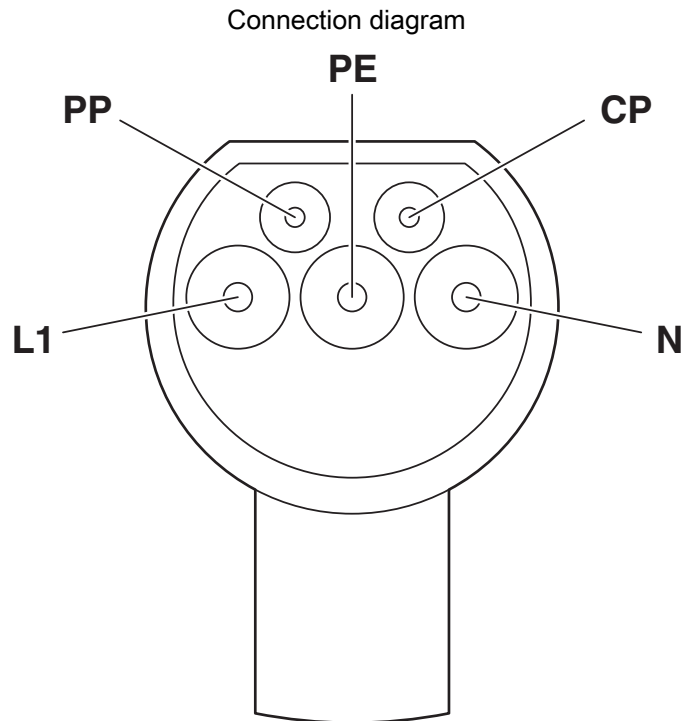

Pin assignment of Infrastructure Plug

AC charging cable - EV-T2G3P-1AC20A-4,0M2,5EHBK01

1627731

<https://www.phoenixcontact.com/gb/products/1627731>

Schematic diagram

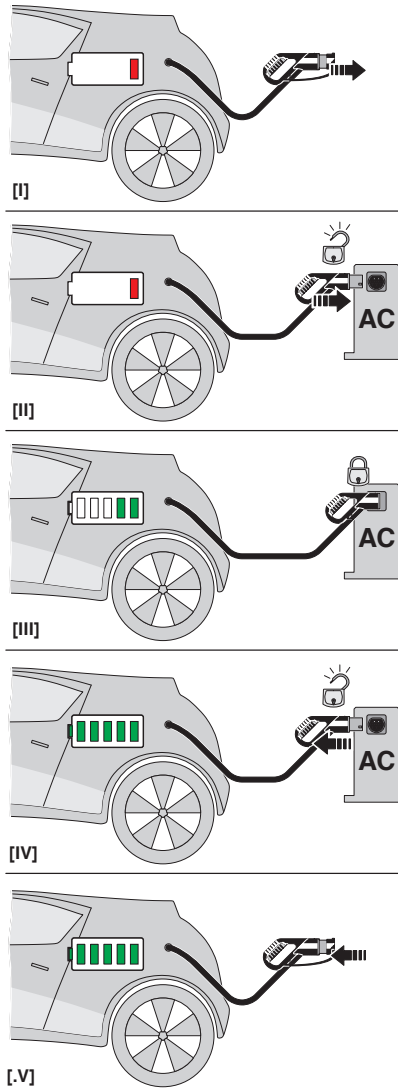

Operating instructions

AC charging cable - EV-T2G3P-1AC20A-4,0M2,5EHBK01



1627731

<https://www.phoenixcontact.com/gb/products/1627731>

Approvals

| IECEE CB Scheme  | Nominal Voltage U_N | Nominal Current I_N | Cross Section AWG | Cross Section mm^2 |
|--|-----------------------|-----------------------|-------------------|-----------------------------|
| | 250 V | 20 A | - | - |

| VDE Zeichengenehmigung  | Nominal Voltage U_N | Nominal Current I_N | Cross Section AWG | Cross Section mm^2 |
|--|-----------------------|-----------------------|-------------------|-----------------------------|
| | 250 V | 20 A | - | - |

AC charging cable - EV-T2G3P-1AC20A-4,0M2,5EHBK01



1627731

<https://www.phoenixcontact.com/gb/products/1627731>

Classifications

ECLASS

| | |
|---------------|----------|
| ECLASS-9.0 | 27144705 |
| ECLASS-10.0.1 | 27144705 |
| ECLASS-11.0 | 27144705 |

ETIM

| | |
|----------|----------|
| ETIM 8.0 | EC002897 |
|----------|----------|

UNSPSC

| | |
|-------------|----------|
| UNSPSC 21.0 | 39121522 |
|-------------|----------|

AC charging cable - EV-T2G3P-1AC20A-4,0M2,5EHBK01



1627731

<https://www.phoenixcontact.com/gb/products/1627731>

Environmental Product Compliance

| | |
|------------|---|
| REACH SVHC | Lead 7439-92-1 |
| China RoHS | Environmentally Friendly Use Period = 10; For details about hazardous substances go to tab "Downloads", Category "Manufacturer's declaration" |

AC charging cable - EV-T2G3P-1AC20A-4,0M2,5EHBK01



1627731

<https://www.phoenixcontact.com/gb/products/1627731>

Accessories

Socket Outlet

Socket Outlet - EV-T2M3SE24-3AC32A-0,7M6,0E10 - 1405216



CHARX connect, Socket Outlet, rear protective cover screw connection, For charging electric vehicles (EV) with alternating current (AC), compatible with infrastructure charging plugs, Type 2, IEC 62196-2, 32 A / 480 V (AC), Single wires, length: 0.7 m, Rear panel mounting, Generation 1, "PHOENIX CONTACT" logo

Phoenix Contact 2022 © - all rights reserved
<https://www.phoenixcontact.com>

PHOENIX CONTACT Ltd
Halesfield 13, Telford
Shropshire, TF7 4PG
01952 681700
info@phoenixcontact.co.uk